

# PRODUCT INFORMATION PACKET

FASCO®

Model No: D471

Catalog No: D471

1/20 HP Refrigeration Motor, 1550 RPM, 208-230 Volts, 3.3" Diameter, Semi Enclosed Fan Cooled  
Refrigeration Motors



Regal and Fasco are trademarks of Regal Beloit Corporation or one of its affiliated companies.  
©2019 Regal Beloit Corporation, All Rights Reserved. MC017097E

REGAL



**Nameplate Specifications**

Output HP	<b>1/20 Hp</b>	Output KW	<b>0.04 kW</b>
Frequency	<b>60 Hz</b>	Voltage	<b>208-230 V</b>
Current	<b>1.10 A</b>	Speed	<b>1550 rpm</b>
Service Factor	<b>1</b>	Phase	<b>1</b>
Duty	<b>Air Over</b>	Insulation Class	<b>B</b>
Frame	<b>3.3</b>	Enclosure	<b>Open Air Over</b>
Thermal Protection	<b>Thermally Protected</b>	Ambient Temperature	<b>40 °C</b>
UL	<b>Recognized</b>	CSA	<b>Y</b>
CE	<b>N</b>		

**Technical Specifications**

Electrical Type	<b>Shaded Pole</b>	Starting Method	<b>Across The Line</b>
Poles	<b>4</b>	Rotation	<b>Counterclockwise Shaft End</b>
Mounting	<b>Extended Studs</b>	Drive End Bearing	<b>Sleeve</b>
Opp Drive End Bearing	<b>Sleeve</b>	Frame Material	<b>Steel</b>
Shaft Type	<b>Flat &amp; Groove</b>	Overall Length	<b>7.18 in</b>
Frame Length	<b>2.82 in</b>	Shaft Diameter	<b>0.313 in</b>
Shaft Extension	<b>2.5 in</b>		

This is an uncontrolled document once printed or downloaded and is subject to change without notice. Date Created:29/10/2019

20	ADD WATER SLINGER TO MOTOR SHAFT.	KSA 07-27-09	21	CHG LEAD MATERIAL TO PVC.	SMC 10/21/09	22	REVISED PACKING AND ADDED CARTON LABEL NOTES	4004800 MLM 03/06/12	STANDARD TOLERANCES: ANGULAR +/- 1 DEGREE 2 PLACE DECIMAL +/- .01 3 PLACE DECIMAL +/- .005
----	-----------------------------------	--------------	----	---------------------------	--------------	----	--	-------------------------	---

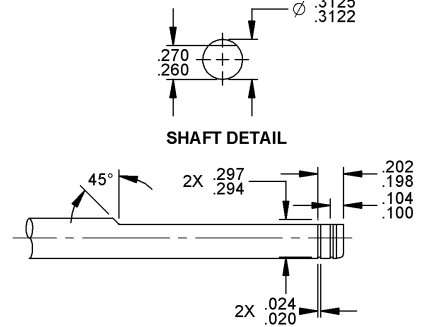
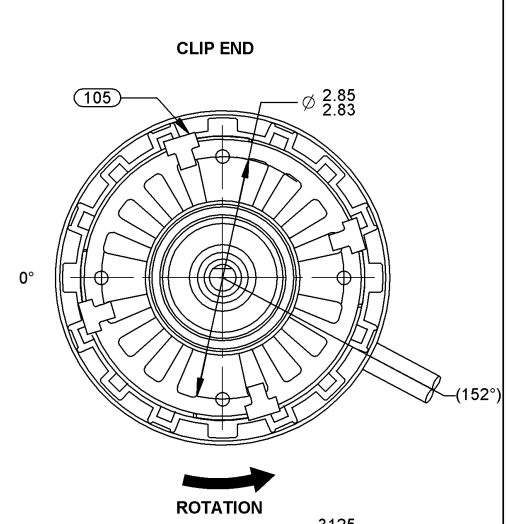
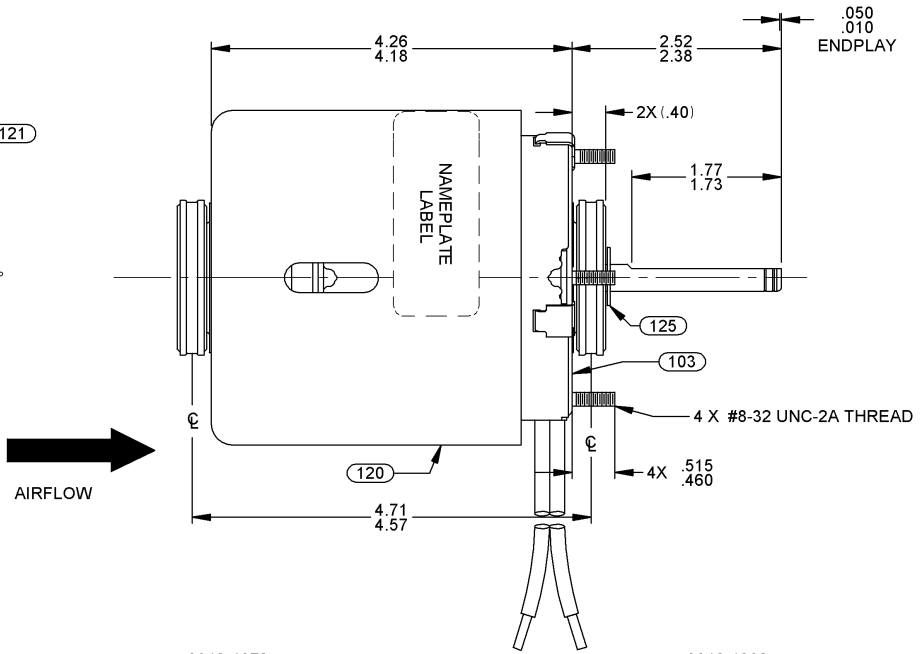
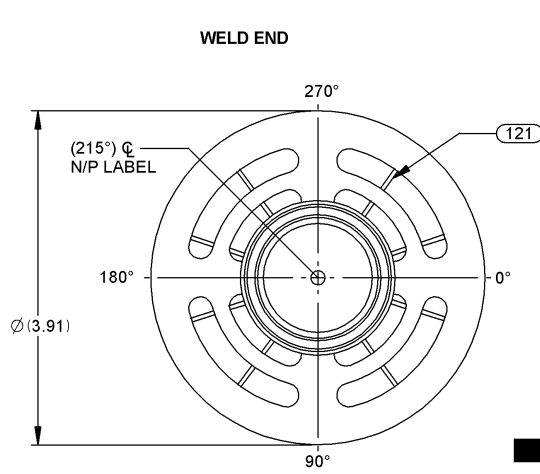

LEAD MATERIAL  
18 GA. 105°C 4/64 INSUL.  
(2) COND. PARALLEL  
PVC, BLACK,  
37.00/33.00 IN. LONG  
3.25/2.75 IN. RIP  
.56/.44 IN. STRIP

0046-4072

0046-4282

**FASCO** Fasco Industries, Inc. Motor Division

Assembled in Mexico

No. 71637922	TYPE U63B1	T.P. AO
208-230 V	60Hz	Class B
1.1 A	1550 RPM	1/20 HP
Model D471		Max Amb: 40°C
LR6319		

**SAFETY WARNING**

This Motor Must Be Grounded in Accordance With Local Or National Electrical Codes To Prevent Possible Injury Due To Electrical Shock

61299553

NOTES:  
210 MAX. MOTORS PER PALLET.  
NO PACKAGING TAPE OVER CARTON LABEL.

FRONT SHAFT POSITION		* TYPICAL PERFORMANCE AT 208-230 VOLTS 60 Hz.										CUSTOMER: FASCO DIST.		<div style="text-align: center;"><b>FASCO</b> FASCO MOTORS GROUP AC MOTOR/BLOWER DIVISION</div> <p style="font-size: x-small;">CONFIDENTIAL; DO NOT DUPLICATE OR DISCLOSE TO THIRD PARTIES WITHOUT WRITTEN PERMISSION OF FASCO MOTORS GROUP, AC MOTOR/BLOWER DIVISION.</p>											
HORIZONTAL		MOTOR SPEED	IDLE			LOADED			LOCKED			BREAK	PART NUMBER: D471							APPLICATION:					
			R.P.M.	AMP.	WATT	IN.OZ.	R.P.M.	AMP.	WATT	IN.OZ.	AMP.	WATT	IN.OZ.	MOTOR WEIGHT: 4.69 POUNDS		MOTOR TYPE		DRAWING NUMBER							
CUSTOMER APPROVAL:		208 V	1755	.83	83	34.7	1550	.97	126	18.9	1.41	183	41.9	ENVIRONMENT: DRY		<b>SHADED POLE</b>									
SIGNED:		230 V	1760	.94	101	42.6	1550	1.07	156	21.2	1.60	231	52.5	FINISH COLOR: BLACK		<b>7163 7922</b>									
DATE:														DRAWN BY: TAMMY JONES		B	LA	FR	A	S	C	E	B	A	REV.
														DATE DRAWN: MARCH 20, 2001		00	63	28	V	06	JW	5	3	0	<b>22</b>