

JOB: UNIT TAG: ENGINEER: CONTRACTOR:	REPRESENTATIVE: ORDER NO. SUBMITTED BY: APPROVED BY:	DATE: DATE: DATE:
---	---	--

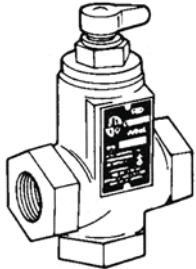

STRAIGHT-ANGLE PATTERN
 3/4"-1"-1 1/4"-1 1/2"-2"*
 *Flanged one end on Horizontal Run.

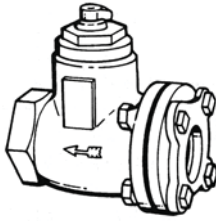

STRAIGHT PATTERN
 2 1/2"-3"-4"

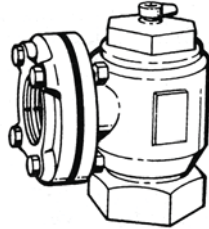

ANGLE PATTERN
 2 1/2"-3"

Flo-Control™ Valves Valves and Fittings

DESCRIPTION

B&G Flo-Control Valves are used for preventing gravity flow in forced water systems and to permit summer-winter operation of indirect water heaters. Flo-Control Valves in NPT sizes 3/4" to 2" are made in combination straight-angle patterns permitting installation in either horizontal or vertical pipe lines. Larger sizes may be furnished in either straight or angle patterns.

CONSTRUCTION

Iron with screwed and flanged ends or Bronze valves with sweat connections.
 Packing & Gasket: Asbestos-Free

SCHEDULE

MODEL NUMBER	PART NUMBER	SIZE INCHES	BODY CONSTRUCTION	TAGGING INFORMATION	QUANTITY
SA 3/4	107034	3/4	Iron		
SA 1	107018	1	Iron		
SA 1-1/4	107019	1-1/4	Iron		
SA 1-1/2	107020	1-1/2	Iron		
SA 2	107021	2	Iron		
A 2-1/2	107006	2-1/2	Iron		
A 3	107007	3	Iron		
S 2-1/2	107014	2-1/2	Iron		
S 3	107015	3	Iron		
S4	107004	4	Iron		
SB 3/4	107024	3/4	Bronze		

PERFORMANCE CHARACTERISTIC CURVE

MAXIMUM WORKING PRESSURE: 125 PSIG (862 kPa) – MAXIMUM OPERATING TEMPERATURE: 250°F (121°C)

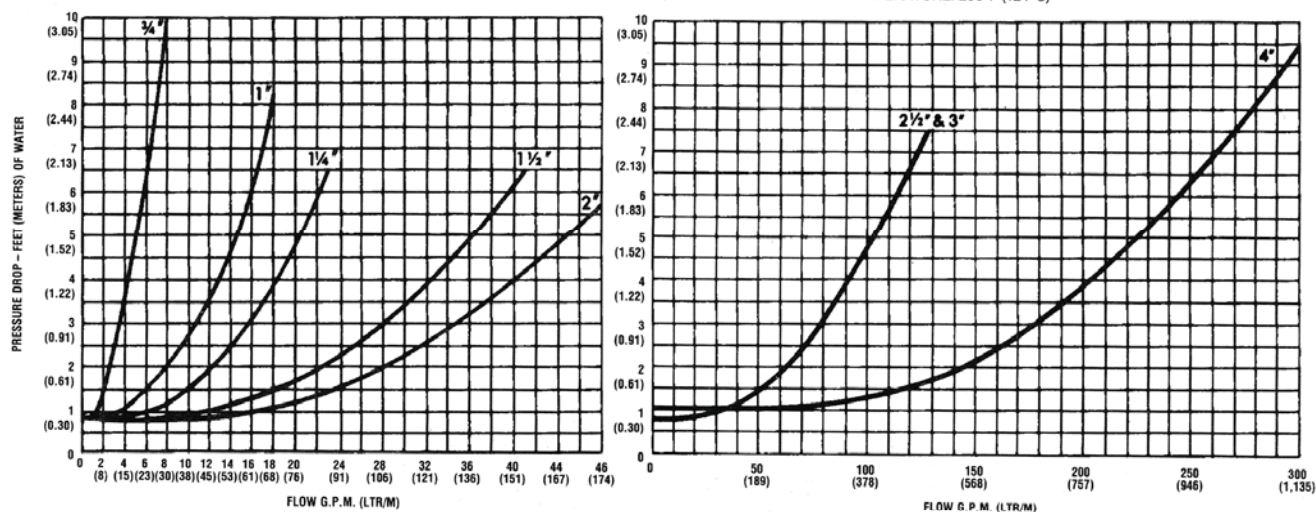

DIMENSIONS AND WEIGHTS

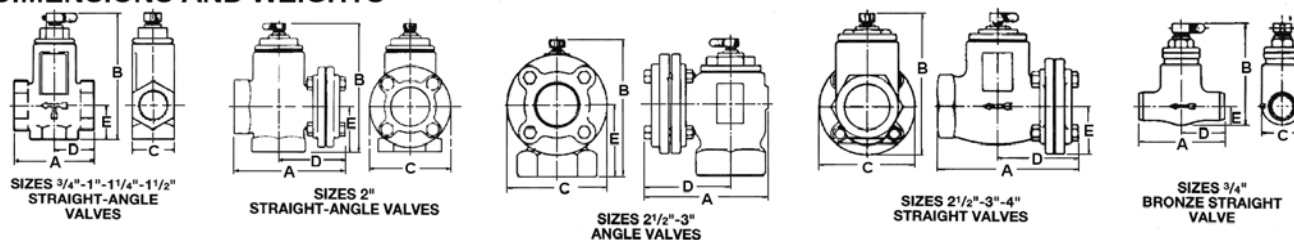

MODEL NUMBER	DIMENSIONS IN INCHES (MM)					APPROX. SHPG. WT. EACH LBS. (Kg)
	A	B	C	D	E	
SA 3/4	3-1/8 (80)	4-15/16 (126)	1-5/8 (42)	1-9/16 (40)	1-7/16 (37)	2 (.9)
SA 1	3-1/2 (89)	5-1/2 (140)	1-7/8 (48)	1-3/4 (45)	1-1/2 (39)	3 (1.3)
SA 1-1/4	4 (102)	6-1/2 (165)	2-1/4 (57)	1-31/32 (50)	1-7/8 (48)	4 (1.8)
SA 1-1/2	5 (127)	7-1/4 (184)	3 (76)	2-1/2 (64)	2-1/4 (57)	8 (3.6)
SA 2	6-7/8 (175)	7-1/2 (191)	4-5/8 (117)	4 (102)	2-5/8 (67)	12 (5.5)
A 2-1/2	7-1/4 (184)	7-5/8 (194)	5-3/8 (137)	4-1/2 (114)	4-1/8 (105)	20 (9.1)
A 3	7-1/2 (191)	7-3/4 (197)	6 (152)	4-1/2 (114)	4-1/4 (108)	23 (10.5)
S 2-1/2	9-5/16 (237)	8-11/16 (221)	5-3/8 (137)	4-3/4 (121)	2-11/16 (68)	22 (10.0)
S 3	9-15/16 (252)	9 (229)	6 (152)	5-1/4 (133)	3 (76)	24 (10.9)
S4	13 (330)	12-1/2 (318)	7-3/4 (197)	7 (178)	3-7/8 (98)	58 (26.4)
SB 3/4	3-1/4 (83)	3-7/8 (98)	1-7/16 (37)	1-5/8 (41)	23/32 (18)	1.2 (.6)

Do not use for construction. Dimensions are approximate and subject to change. Contact factory for certified dimensions.

TYPICAL SPECIFICATION

Furnish and install as shown on plans a _____ body (Select one: cast iron or bronze), _____ pattern (Select one: angle, straight or straight-angle), flow control valve(s) suitable for 125 psig (862 kPa) working pressure at a maximum operating temperature of 250°F (121°C). The valves shall have _____, _____ connections

(Select one: NPT or sweat), and be equipped with a bronze vertical lift disc designed to prevent gravity circulation during normal system "off" cycles. The valve shall feature a manual open position for gravity circulation. Each flow control valve shall be Xylem Bell & Gossett Model No. _____ Flo-Control Valve.

Xylem Inc.
8200 N. Austin Avenue
Morton Grove, IL 60053
Phone: (847)966-3700
Fax: (847)965-8379
www.xyleminc.com/brands/bellgossett

Bell & Gossett is a trademark of Xylem Inc. or one of its subsidiaries.
© 2012 Xylem Inc.

xylem
Let's Solve Water