

# Lead Free Brass EzPress Tankless Water Heater Valve Kit

## Feature

600# WOG (non-shock)  
 Lead free brass construction  
 ¼ turn operation  
 Full port  
 Adjustable packing  
 Blow-out proof stem  
 Integral hose end drain/purge valve  
 EzPress end x FNPT tailpiece (ASME B1.20.1-NPT)  
 Integral relief valve port (3/4")  
 3430LRAB: 200K BTU/hr relief  
 3430LSAB: 500K BTU/hr relief  
 3430LTAB: 2.7M BTU/hr relief  
 AB1953, NSF/ANSI 61 & 372 certified



3431LAB: Hot valve operation (red handle)  
 3432AB: Cold valve operation (blue handle)

## Material

	Part	Material	Specification
1	Body	Lead Free Brass	ASTM B927 C27450
2	Fixed end	DZR Lead Free Brass	ASTM B927 C27453
3	Ball	Lead Free Brass / Cr plated	ASTM B927 C27450
4	Seat	PTFE	PTFE
5	O-ring	EPDM Perox	NSF approved
6	Stem	Lead Free Brass	ASTM B927 C27450
7	Packing ring	PTFE	PTFE
8	Packing nut	Brass	ASTM B124 C37700
9	T-handle	Aluminum	ASTM B85
10	Handle nut	Steel /Zn plated	ASTM A36
11	Handle screw	Steel /Zn plated	ASTM A36
12	Handle	Aluminum	ASTM B85
13	Stem	Lead Free Brass	ASTM B927 C27450
14	Union nut	Brass	ASTM B283 C37700
15	Union	Lead Free Brass	ASTM B927 C27450
16	O-ring	EPDM Perox	NSF approved
17	Cap retainer	Rubber	-
18	Drain cap	Brass	ASTM B283 C37700
19	Drain gasket	EPDM Perox	NSF approved
20	Ball	Lead Free Brass / Cr plated	ASTM B927 C27450
21	Seat	PTFE	PTFE
22	Fixed end	Lead Free Brass	ASTM B927 C27450

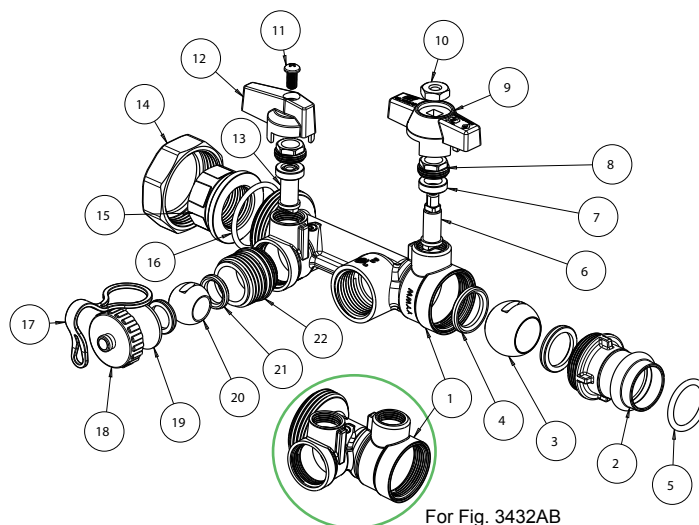

For Fig. 3432AB

## Dimension, Weight

Size	ΦNPT [in]	ΦSC [in]	Φ [in]	ΦSL [in]	ΦP [in]	A* [in]	B [in]	H [in]	Wt.* [lb]
¾"	¾ - 14NPT	¾ - 14NPT	0.86	0.50	0.73	6.95 / 4.78	2.35	1.66	1.71 / 1.68

\* 3431LAB / 3432AB

